

Eastwood[®]

DO THE JOB RIGHT.[®]

Item #14772

CONCOURS[®] PRO **HVLP DETAIL PAINT GUN** **INSTRUCTIONS**

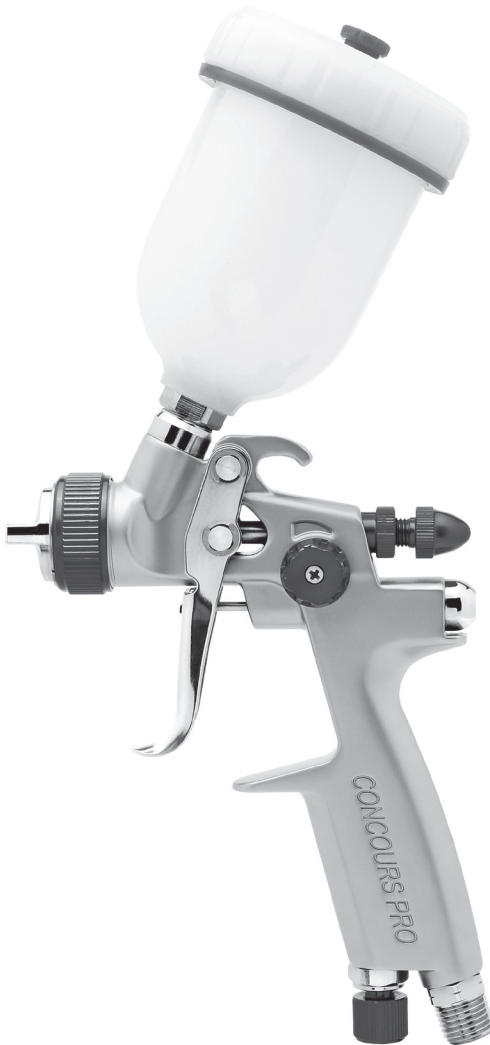

The **EASTWOOD CONCURS® PRO HVLP DETAIL PAINT GUN** is a top quality, true professional level paint gun specifically designed for optimal internal paint and air flow. With high precision and excellent control, this detail gun is fully capable of producing results equal or superior to other high-end HVLP detail guns.

CONTENTS

- (1) HVLP Paint Gun with 1.0mm Fluid Nozzle
- (1) .8mm Needle/Nozzle/Air Cap
- (1) 100ml. Plastic Paint Cup
- (1) Cup Filter
- (1) Cleaning Set
- (1) Manifold Removal Tool

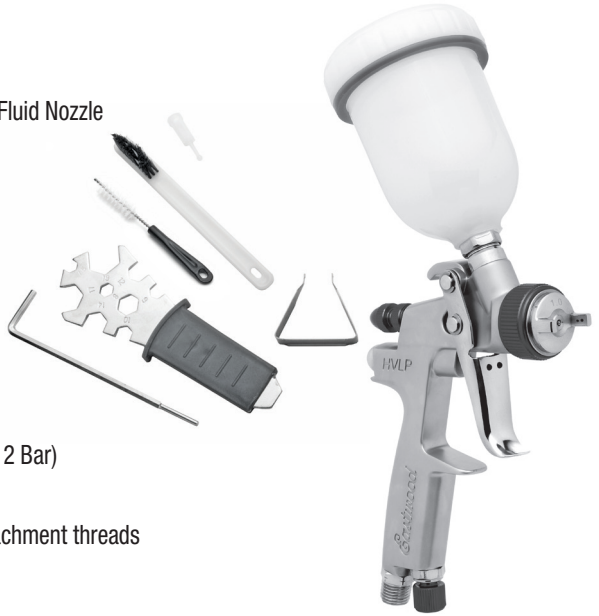

SPECIFICATIONS

- 3 CFM @ 19 to 22 psi (1.5 to 2 Bar)
- 1/4" male NPT input threads
- M14 x 1.0 NPS paint cup attachment threads

SAFETY INFORMATION

The following explanations are displayed in this manual, on the labeling, and on all other information provided with this product:

⚠ DANGER

DANGER indicates a hazardous situation which, if not avoided, will result in death or serious injury.

⚠ WARNING

WARNING indicates a hazardous situation which, if not avoided, could result in death or serious injury.

⚠ CAUTION

CAUTION used with the safety alert symbol, indicates a hazardous situation which, if not avoided, could result in minor or moderate injury.

⚠ NOTICE

NOTICE is used to address practices not related to personal injury.

SAFETY INFORMATION



⚠️ READ INSTRUCTIONS

- Thoroughly read and understand this manual before using.
- Save for future reference.



⚠️ DANGER FIRE AND EXPLOSION HAZARD!

- Do Not use near sparks, open flame or other potential ignition source.



⚠️ WARNING HEALTH HAZARD

- Avoid breathing vapors produced by Spray Gun. Always wear appropriate NIOSH approved breathing apparatus and use in a well ventilated area.
- Wear appropriate eye protection.
- Wear solvent-resistant gloves.

SET-UP

- Remove all components from carton, identify them and become familiar with their purpose.
- A 5/16" I.D. minimum air hose at a 25' maximum length is strongly recommended for best results. Smaller I.D. hose and greater length may produce unsatisfactory results.
- A clean, dry, regulated air supply is required. The use of an additional "on the gun" regulator is strongly recommended to accurately control gun pressure while painting.
- Clean out the paint cup as well as the paint gun air and paint passages with a solvent such as Eastwood PRE or acetone to remove any residual manufacturing impurities before use. Dry thoroughly.

GUN SETTINGS

- **Air Cap** – Make sure the Air Cap is properly oriented in a horizontal plane to produce a vertical fan spray pattern by viewing the HVLP Paint Gun from the front. To adjust, loosen Retaining Ring by rotating counter-clockwise slightly, adjust Air Cap then re-tighten Retaining Ring (**FIG A**).
- **Fluid Control** – The Fluid Control knob (located at top rear of gun body) regulates the distance the Needle travels and the amount of paint flowing through the gun. **NOTE:** Generally for higher viscosity coatings, a wider opening is desired while a closer opening is better suited for lower viscosity fluids. To adjust, rotate the Fluid Control Knob outward (counter-clockwise as viewed from the rear) to increase flow and turn inward to reduce flow (**FIG A**).
- **Fan Control** – The Fan Control knob (located at the upper left side of the paint gun body) controls the size and shape of the spray pattern of “fan”. Rotating the knob counterclockwise will produce a larger and softer spray pattern while result in a smaller, sharper pattern. For most painting conditions, a larger, softer fan is desired (**FIG A**).
- **Air Control** – The Air Control knob (located at the bottom of the gun handle adjacent to the air inlet) is opened by rotating in a counter-clockwise direction (as viewed from the bottom of the gun). This is for “fine tuning” the airflow to the gun. You will generally want to set the inlet pressure at the regulator, start with the Air Control in the full open position and decrease air as needed (**FIG A**).
- When you have achieved your optimal knob settings, note their positions with the indicators on the gun body and knobs. This will assist in quickly “tuning” the gun in future uses.
- With practice, you will quickly acquire a “feel” for the gun & will be producing professional results.

FIG. A

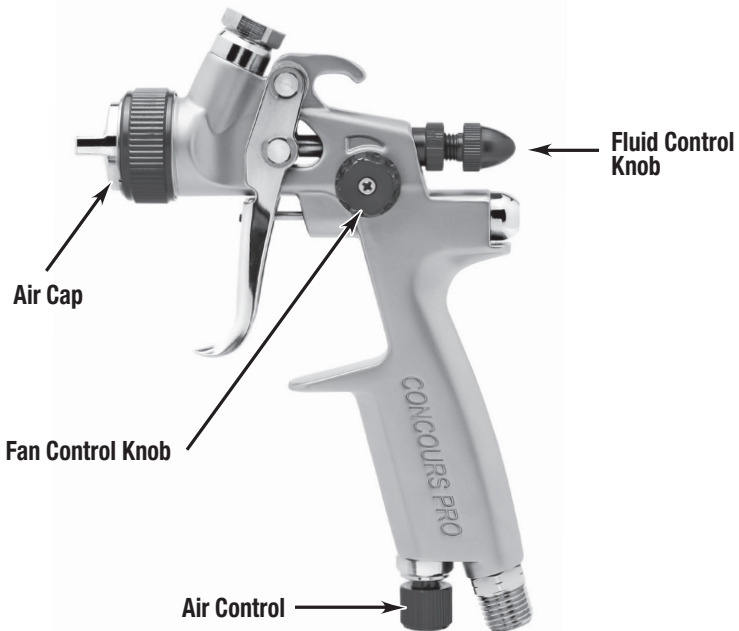

IMPORTANT NOTES BEFORE PAINTING

1. Please note that many variables may affect the adjustment of a paint gun including paint viscosity and type, atmospheric conditions such as humidity, barometric pressure and temperature, as well as air inlet pressure and operator preference. Always “tune” the gun before each use as prevailing conditions may not be the same as the previous use.
2. It is always best to test spray, the actual paint you will be applying, on sheets of cardboard or masking paper while making your adjustments to become familiar with the gun and achieve the ideal Fluid Control Setting.
3. Remember that a small amount of product wasted at this point can avoid disappointment in your results and the need to re-do your work later.

CLEAN-UP

- Disconnect air supply to gun.
- Pour unused coating into proper container.
- Remove Paint Cup and wipe out any excess coating, then thoroughly rinse the Paint Cup with a mild solvent compatible with the coating being used.
- Attach Paint Cup and then pour a small amount of a solvent compatible with the paint being used in the Paint Cup. Reconnect air supply then spray solvent through HVLP Gun in a safe area until it flows clear. **NOTE:** As an alternative, #12846Z Eastwood Aerosol Injected Gun Cleaner is excellent for this purpose.
- Remove air supply from HVLP Gun.
- Pour out any unused solvent and remove paint cup.
- Allow solvent to dry completely from all components.

PAINT GUN DISASSEMBLY FOR ADDITIONAL CLEANING OR REBUILDING

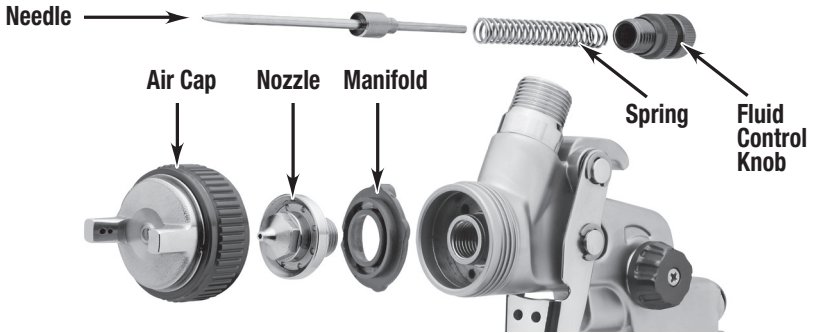

- Remove Air Cap Assembly.
- Remove Nozzle with an 8mm wrench (included).
- Unthread and remove Fluid Control Knob from rear of Paint Gun body.
- Carefully remove Tension Coil Spring with Bushing and Needle by firmly gripping rear of Needle and pulling out through rear of Paint Gun Body (**FIG B**).
- Remove brown plastic Air Manifold (note position of locating pin on manifold to bore in Paint Gun body for re-assembly) with special removal tool by placing hooks facing downward, through manifold openings, under spokes and pulling directly outward toward front of Gun Body (**FIG C & D**).
- Inspect and clean as required.
- Replace Air Manifold (be sure to correctly position the locating pin on manifold into bore in Paint Gun Body).
- Replace Needle by sliding into bore in rear of Paint Gun Body until it seats.
- Slide Needle Tension Spring w/bushing over the rear of the Needle (**FIG E**).
- Replace Nozzle by threading into front of Gun Body and tighten firmly with included 8mm wrench.
- **CAUTION:** Do not over tighten.
- Replace Air cap by threading Retaining Ring onto Gun Body. Make sure the air horns of the Air Cap are oriented properly.

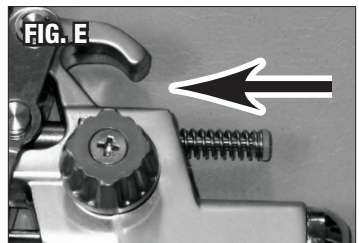
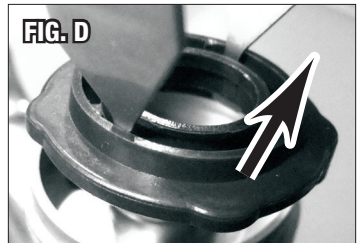
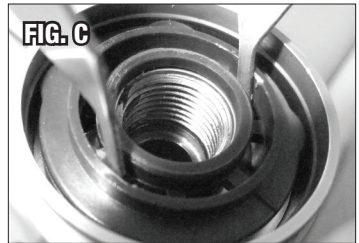
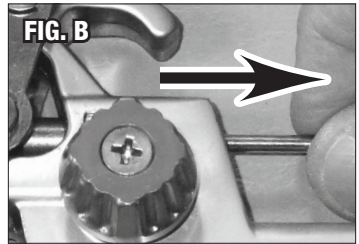

TROUBLESHOOTING

PROBLEM	CAUSE	CORRECTION
Gun Produces an Uneven Spray Pattern or Fan	Paint or film buildup on Air Cap blocking air holes	Disconnect air supply and clean buildup from Air Cap.
Gun "Spits" or Sputters; Discharges Large Droplets	Paint or film buildup on Needle & Nozzle	Disconnect air supply and clean buildup from Needle & Nozzle. NOTE: Use of solvent may be helpful, removal of the Nozzle may be necessary.
Gun Draws Only a Small Amount of Paint or None At All	Clump or piece of paint film blocking Pickup Tube	Disconnect air supply; remove Paint Cup and Pickup Tube. Remove blockage from Pickup Tube then strain paint or coating to remove clumps or film.

ADDITIONAL ITEMS

#10041Z	Eastwood PRE Painting Prep, Aerosol
#12846Z	Aerosol Injected Cleaner
#14829	Gerson One Step P95 Respirator
#20403-#20406	Gen-Nex Painters Coveralls
#31633	Eastwood Air CFS
#16186	Eastwood Professional Paint Gun Cleaning Set
#14771	Eastwood Concours PRO HVLP Paint Gun

If you have any questions about the use of this product, please contact

The Eastwood Technical Assistance Service Department: 800.343.9353 >> email: tech@eastwood.com

PDF version of this manual is available at eastwood.com

The Eastwood Company 263 Shoemaker Road, Pottstown, PA 19464, USA

800.343.9353 eastwood.com