

16PC HVLP PAINT GUN SET

INSTRUCTIONS

Item #15214



The 16pc HVLP Paint Gun Set provides a comprehensive array of paint guns and equipment required to do a complete paint job from primer, sealer, base coat, through to clear coat. The detail gun allows for precise application of paint to door jambs, trunk areas, spot repairs, and more.

SAFETY INFORMATION



READ INSTRUCTIONS!

Thoroughly read and understand this instruction manual before use. Save manual for future reference to safety warnings, maintenance and operating procedures. Failure to follow all warnings can result in tool damage or serious physical injury.



FIRE AND EXPLOSION HAZARD!

Do Not use near sparks, open flame or other potential ignition source. Solvents and paints are highly combustible and may ignite or explode. Keep at least 25' away from any non-explosion proof compressors, motors, switches etc.



HEALTH HAZARD!

- Avoid breathing vapors produced by Spray Gun. Always wear appropriate NIOSH approved breathing apparatus and use in a well ventilated area.
- Wear appropriate ANSI standard Z87.1 eye protection.
- Wear solvent-resistant gloves.
- Do not allow unprotected persons or pets in the spray area.



OPERATIONAL HAZARD!

- Do Not exceed 60 PSI at any time or permanent gun damage and or fragmentation could occur.
- Always disconnect gun from pressurized air source when adding paint, cleaning and servicing or when not in use.
- Use only approved Eastwood solvents, acetone or lacquer thinner to clean guns. Use of chlorinated or halogenated hydrocarbon solvents can corrode aluminum gun components or emit hazardous reactive gasses.
- Use for spraying paint products only. Do not use for spraying pesticides, fertilizer, acids or other corrosive materials and solvents.

SPECIFICATIONS

- Detail Gun, 1.0mm Needle/Nozzle; 18 PSI (1.2 Bar)
- 1.4mm Needle/Nozzle Gun; 12 CFM @ 29 PSI (2 Bar)
- 1.8mm Needle/Nozzle Gun; 12 CFM @ 33 PSI (2.3 Bar)
- All: 1/4" male NPT input threads
- 1.4mm HVLP Paint Gun Cup Threads: M16 x 1.5
- 1.8mm HVLP Paint Gun Cup Threads: M16 x 1.5
- 1.0mm HVLP Detail Paint Gun Cup Threads: M14 x 1.0

INCLUDES

- (1) HVLP Paint Gun with 1.4mm needle/nozzle set
- (1) HVLP Paint Gun with 1.8mm needle/nozzle set
- (1) HVLP Detail Paint Gun with 1.0mm needle/nozzle set
- (1) 1000ml. aluminum Paint Cup
- (1) 600ml. aluminum Paint Cup
- (1) 250ml. aluminum Paint Cup
- (3) 100 Micron gun Cup Filters
- (2) Regulator/Gauges
- (1) Paint Gun Wrench
- (4) Paint Gun Cleaning Brushes
- (1) Heavy-Duty Plastic Case



SET-UP

1. Remove all components from case, identify them and become familiar with their purpose.
2. **Before First Use** – Following Gun Cleaning Procedure, clean out the paint cup, nozzle as well as the paint gun internal air and paint passages with a solvent such as, Eastwood PRE (10041Z) or Aerosol Injected Cleaner (12846Z) to remove any residual manufacturing impurities or lubricants that may be present. Dry thoroughly.
3. A 5/16" I.D. *minimum* air hose at a 25' *maximum* length is strongly recommended for best results. Smaller I.D. hose and greater length may produce unsatisfactory results.
4. A clean, dry, regulated air supply is required.
5. Attach one of the included “on the gun” regulators to accurately control gun pressure while painting.

GUN SETTINGS:

- **Air Cap** – Make sure the Air Cap is properly oriented in a horizontal plane to produce a vertical fan spray pattern by viewing the HVLP Paint Gun from the front. To adjust, loosen Retaining Ring by rotating counter-clockwise slightly, adjust Air Cap then re-tighten Retaining Ring.
- **Fluid Control** – The Fluid Control knob (located at top rear of gun body) regulates the distance the Needle travels and the amount of paint flowing through the gun. Note: Generally for higher viscosity coatings, a wider opening is desired while a closer opening is better suited for lower viscosity fluids. To adjust, rotate the Fluid Control Knob outward (counter-clockwise as viewed from the rear) to increase flow and turn inward to reduce flow.
- **Fan Control** – The Fan Control knob (located at the upper left side of the paint gun body) controls the size and shape of the spray pattern of “fan”. Rotating the knob counterclockwise will produce a larger and softer spray pattern while result in a smaller, sharper pattern. For most painting conditions, a larger, softer fan is desired.
- **Air Control** – The Air Control knob (located at the bottom of the gun handle adjacent to the air inlet) is opened by rotating in a counter-clockwise direction (as viewed from the bottom of the gun). This is for “fine tuning” the airflow to the gun. You will generally want to set the inlet pressure at the regulator, start with the Air Control in the full open position and decrease air as needed.

With practice, you will quickly acquire a “feel” for the paint guns and will be producing professional results.

IMPORTANT NOTES BEFORE PAINTING:

- Please note that many variables affect the adjustment of a paint gun including paint viscosity and type, atmospheric conditions such as humidity, barometric pressure and temperature as well as air inlet pressure and operator preference. Always “tune” the gun before each use as prevailing conditions may not be the same as the previous use.
- It is always best to test spray on sheets of cardboard or masking paper with the actual paint you will be applying while making your adjustments to become familiar with the gun and achieve the ideal Fluid Control Setting.
- Remember that a small amount of product wasted at this point can avoid disappointment in your results and the need to re-do your work later.

CLEAN-UP:

1. Disconnect air supply to gun.
2. Remove Paint Cup and pour unused coating into proper container.
3. Wipe out any excess coating then thoroughly rinse the Paint Cup with a mild solvent compatible with the coating being used.
4. Pour a small amount of a solvent compatible with the paint being used in the Paint Cup then attach Paint Cup, reconnect air supply then spray solvent through HVLP Gun in a safe area until it flows clear. **Note: Eastwood Aerosol Injected Gun Cleaner (12846Z)** is excellent for this purpose.
5. Remove air supply from HVLP Gun.
6. Pour out any unused solvent and remove paint cup.
7. Allow solvent to dry completely from all components.

PAINT GUN DISASSEMBLY FOR ADDITIONAL CLEANING:

- Remove Air Cap by unthreading.
- Remove Nozzle with included wrench.
- Unthread and remove Fluid Control Knob from rear of Paint Gun body.
- Carefully remove Tension Coil Spring with Bushing and Needle by firmly gripping rear of Needle and pulling out through rear of Paint Gun body.
- Inspect and clean as required.
- Replace Needle by sliding into bore in rear of Paint Gun body until it seats.
- Slide Needle Tension Spring w/bushing over the rear of the Needle.
- Replace Nozzle by threading into front of Gun Body and tighten firmly with included wrench. (Caution: do not-over tighten).
- Replace Air cap by threading onto Gun Body. Make sure the air horns of the Air Cap are oriented properly.

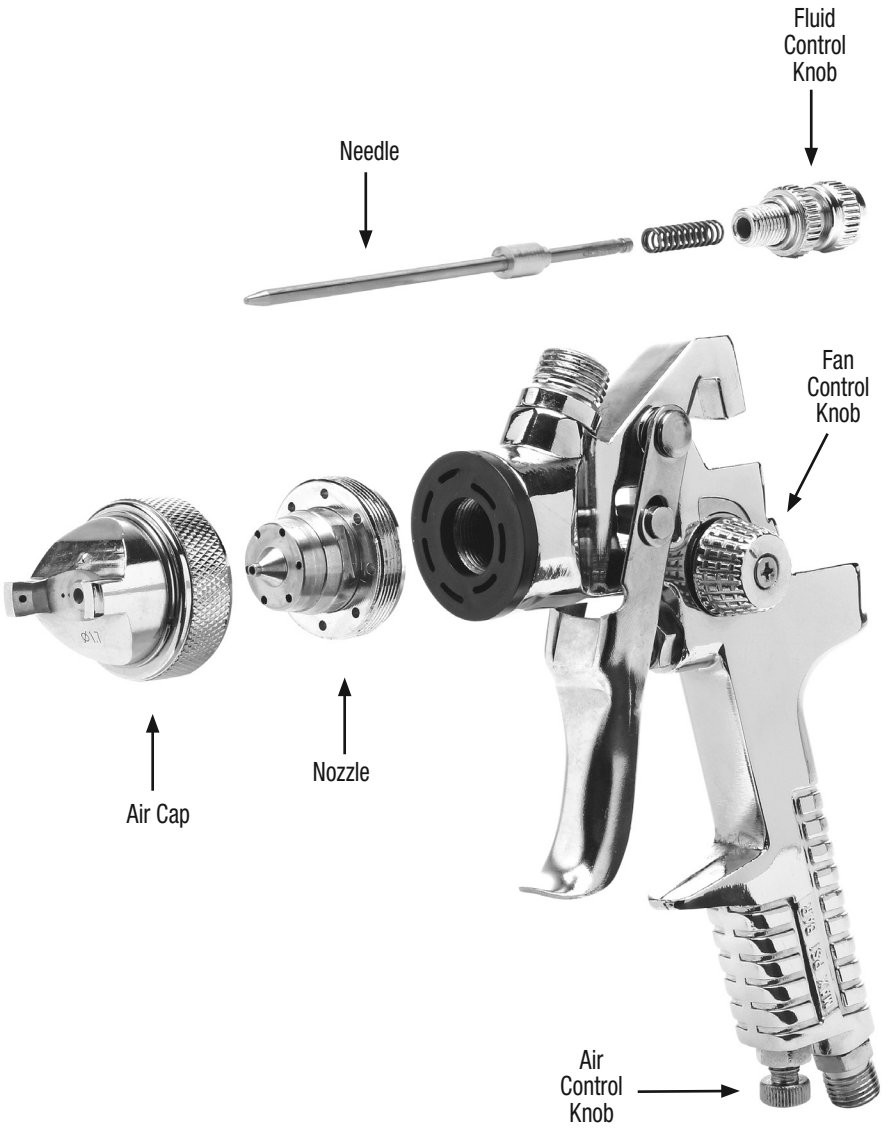

TROUBLESHOOTING

- **Gun produces an uneven spray pattern or fan:**
 - Paint or film buildup on Air Cap blocking air holes.
Disconnect air supply and clean buildup from Air Cap.
- **Gun “spits” or sputters; discharges large droplets:**
 - Paint or film buildup on Needle & Nozzle.
Disconnect air supply and clean buildup from Needle & Nozzle.
Note: Use of solvent may be helpful, removal of the Nozzle may be necessary.

ADDITIONAL ITEMS

#10041Z	Eastwood PRE Painting Prep, Aerosol
#12846Z	Aerosol Injected Cleaner
#11455-11456	Respirators
# 20403-20406	Coveralls
# 12569	Master Gun Cleaning Kit
# 12817	Paint Gun Accessory Kit
# 21506	3 Paint Gun Stand
# 34131	13 Piece Mixing Cup Set

If you have any questions about the use of this product, please contact

The Eastwood Technical Assistance Service Department: 800.544.5118 >> email: techhelp@eastwood.com

PDF version of this manual is available online >> eastwood.com/20124manual

The Eastwood Company 263 Shoemaker Road, Pottstown, PA 19464, USA

US and Canada: 800.345.1178 Outside US: 610.718.8335 Fax: 610.323.6268 eastwood.com