

KEVIN TETZ PRESENTS



Thank you for choosing the Paintucation® Spray Coach™!

The Spray Coach is designed to teach you perfect painting techniques, and to develop the muscle memory of painting before spraying the first drop of paint. This accessory is easily installed or removed from your spray gun, and is adjustable to simulate the proper gun-to-surface distance required by paint manufacturers. We appreciate your purchase and congratulate you on wanting to improve your skills! Technique is critical in a successful painting project, and the Spray Coach, combined with practicing the techniques in this manual and DVD, will show you what perfect technique feels like in your hand, body and wrist, eliminating expensive mistakes on your project! Practice makes perfect!

INCLUDES

- (1) Air cap lock ring
- (1) Spray Pattern Simulator
- (2) Allen keys
- (1) Instructional DVD
- (1) Manual

⚠ CAUTION Do not over tighten the threaded fasteners in the lock ring!

Gently snugging the allen screws is enough pressure.

DO NOT SPRAY PAINT THROUGH YOUR GUN WITH THE SPRAY COACH ATTACHED!

SETUP

1. Install the lock ring over your air cap with the pattern simulator hole in line with the air horns of their cap.
2. Gently snug the locking screws with the supplied allen wrench.
3. Insert the spray pattern simulator so that the offset metal shaft is directly in line with the needle orifice in the center of the air cap. Gently snug the allen screw to tighten.
4. Measure your chosen gun distance, depending on the spray materials P-sheets or product guides. A good average distance is 5" from the surface of your project.

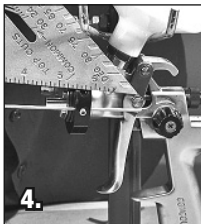
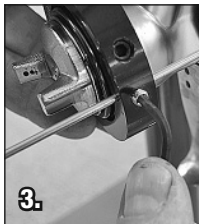

EXERCISES

EXERCISE ONE

Simulate the action of spraying paint while maintaining the spray pattern completely flat to a horizontal surface. Try to keep the simulator barely touching the surface, and perfectly parallel at the same time. Move slowly at first until you develop a “feel” for hovering just above the surface with perfect alignment and technique.

EXERCISE TWO

While looking down at your spray gun in hand, move the gun side to side and keep the gun orientation the same, while flexing your wrist... wrist action is the most important action in spraying paint. Remember that these are skill building exercises that build off the previous step.

EXERCISE THREE

Once you've memorized the feeling in your wrist and you're comfortable working on a flat surface, move to something more complicated... a vehicle is the perfect practice subject, but anything will work.

EXERCISE FOUR

Most vehicles have complex shapes, try practicing on a sloped panel while maintaining perfect technique and alignment to your body.

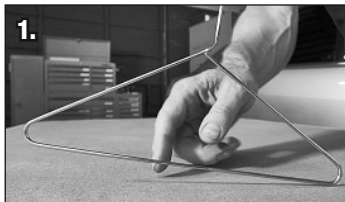

EXERCISE FIVE

Get comfortable with reaching outward over a panel, keeping your body away from the side of the vehicle, and maintain perfect technique... note the feeling of your wrist and hand position as you practice! This should become muscle memory with practice, and remembering the feelings that coach forces you into will remind you of technique when its most important!

EXERCISE SIX

Now attach an airhose to your spray gun. Use your opposite hand to control your hose and keep it off the painting project. Work your way around the vehicle (watch the DVD for tips on where to start and stop on a paint job)

EXERCISE SEVEN

Congratulations! Remove the Spray Coach and set up a practice panel to paint. Remember how the gun felt with the coach attached, and practice painting with a loaded gun! Remember that practice is key, but the Spray Coach will give you a great head start! Happy painting!



CLEANING & MAINTENANCE

Eastwood PRE Painting Prep is an excellent mild solvent that will clean the exterior surfaces of the spray gun coach. ***Remember not to spray paint through your gun with the Spray Coach attached!***