

*Eastwood*  
*Elite*

Items #54276

# PAINT GUN REBUILD KIT

## INSTRUCTIONS

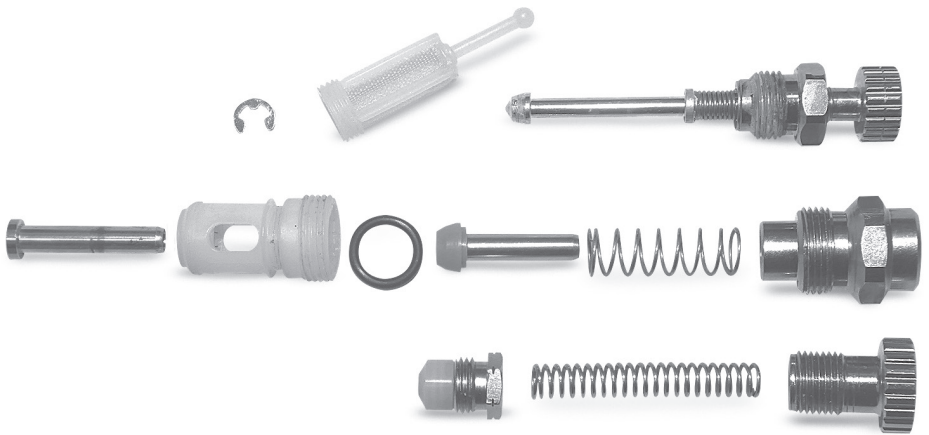

The **EASTWOOD ELITE PAINT GUN REBUILD KIT** includes the common wear parts necessary to restore like-new performance to the #54270 & #54271, Eastwood Elite Paint Guns.

## CONTENTS

- (1) Fluid Adjusting Knob [A]
- (1) Needle Tension Spring [B]
- (1) Fluid Valve Body [C]
- (1) Fluid Valve Spring [D]
- (1) Fluid Valve Seal Sleeve [E]
- (1) Needle Guide Body O-Ring [F]
- (1) Needle Guide Body [G]
- (1) Needle Guide Sleeve [H]
- (1) Needle Packing Ass'y [J]
- (1) Fan Control Valve Ass'y [K]
- (1) Trigger Pivot E-Clip [L]
- (1) Fluid Inlet Filter [M]

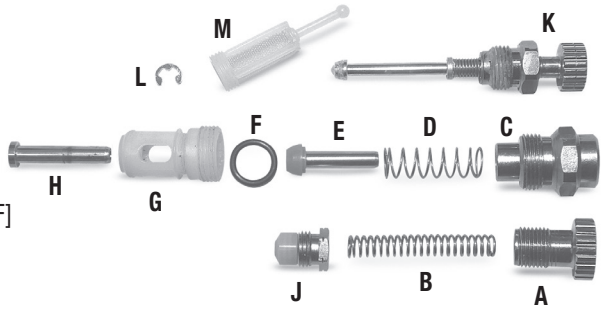

## SAFETY INFORMATION

The following explanations are displayed in this manual, on the labeling, and on all other information provided with this product:

### **⚠ DANGER**

DANGER indicates a hazardous situation which, if not avoided, will result in death or serious injury.

### **⚠ WARNING**

WARNING indicates a hazardous situation which, if not avoided, could result in death or serious injury.

### **⚠ CAUTION**

CAUTION used with the safety alert symbol, indicates a hazardous situation which, if not avoided, could result in minor or moderate injury.

### **⚠ NOTICE**

NOTICE is used to address practices not related to personal injury.



### **⚠ CAUTION**

- The Eastwood Elite Paint Gun must be disconnected from any inlet air supply before disassembly.

# PAINT GUN DISSASSEMBLY FOR REBUILD

## AIR CAP

- Unthread and remove Air Cap assembly (**FIG 1**).

## NOZZLE

- Unthread Nozzle from gun body with the 19mm notch of the paint gun wrench (included with Paint Gun) (**FIG 1**).

## TRIGGER

- Lay the gun body on its side and using a small screwdriver (not included), remove the E-Clip [L] from pivot shaft (**FIG 2**).
- Pull pivot shaft out of gun body and trigger. Set trigger and pivot shaft aside for re-installation (**FIG 3**).

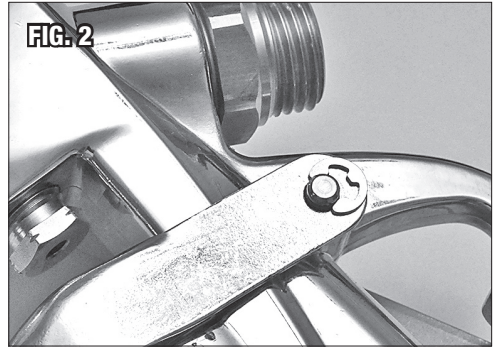
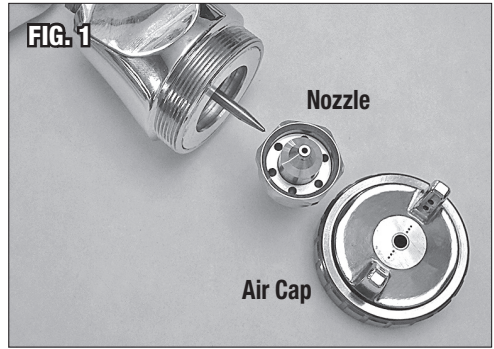

### FLUID CONTROL/NEEDLE

- Unthread and remove Fluid Control Knob [A] from rear of gun body (FIG 4).
- Carefully remove Needle Tension Spring [B] (FIG 5).
- Remove Needle by firmly gripping rear of Needle and pulling out through rear of gun body. Set Needle aside for re-installation if re-using Needle.

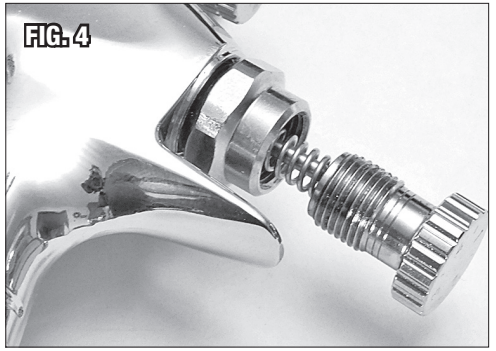

### FLUID VALVE BODY

- Unthread and remove the Fluid Valve Body [C] from rear of gun body with the 17mm notch of the paint gun wrench (included with Paint Gun) (FIG 6).
- Remove Fluid Valve Spring [D] then pull out the Fluid Valve Seal Sleeve [E] (FIG 6).

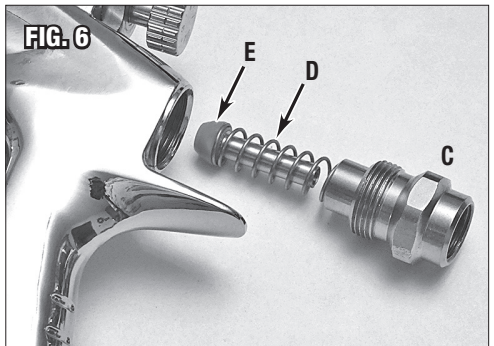
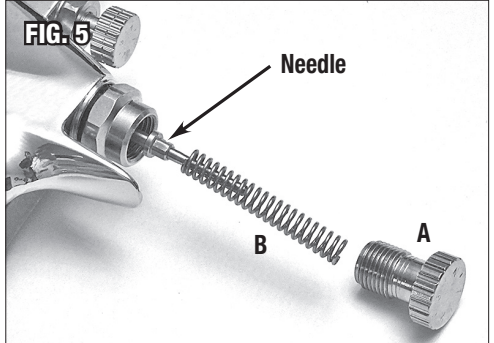

### NEEDLE GUIDE BODY

- Insert a long 10mm hex key (not included) into the hex of the Needle Guide Body (FIG 7), unthread and withdraw it from the bore (FIG 8).

**NOTE:** The Needle Guide Sleeve [H] and Guide Body O-Ring [F] are attached to the Needle Guide Body.

### NEEDLE PACKING ASSEMBLY

- Using the 10mm notch of the paint gun wrench (included with Paint Gun), unthread and withdraw the Needle Packing Ass'y [J] from gun body (FIG 9).

### FAN CONTROL VALVE ASSEMBLY

- Unthread the Fan Control Valve Ass'y [K] from gun body with the 13mm notch of the paint gun wrench (included with Paint Gun) (FIG 10).

The Eastwood Elite Paint Gun is completely disassembled for cleaning and rebuilding.

Inspect and thoroughly clean Gun Body as required. Eastwood #12846Z Aerosol Injected Paint Gun Cleaner, #16154ZP & #16155ZP Paint Gun Cleaner with a #16186 Professional Paint Gun Cleaning Set are all excellent and highly recommended for this purpose.

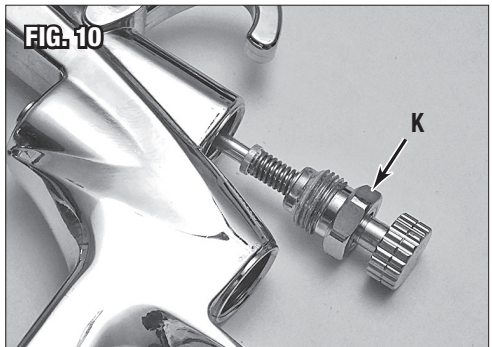
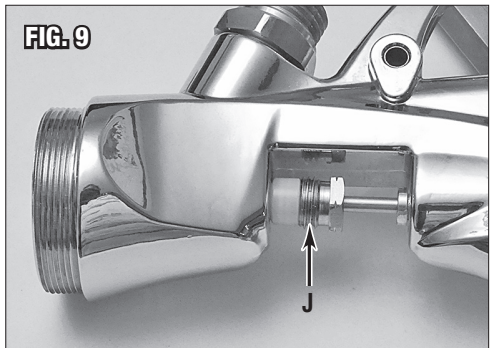
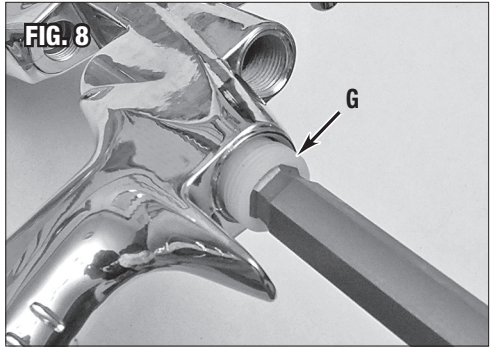

# REASSEMBLY

## FAN CONTROL VALVE ASSEMBLY [K]

- Thread the Fan Control Valve Ass'y [K] into the upper rear gun body and secure with the 13mm notch of the paint gun wrench (included with Paint Gun) (FIG 10).

## NEEDLE PACKING ASSEMBLY [J]

- Thread the Needle Packing Ass'y [J] into gun body and tighten with the 13mm notch of the paint gun wrench (included with Paint Gun) (FIG 9). DO NOT OVERTIGHTEN!
- Temporarily insert the Needle through the bore and into the Packing Ass'y. Slide the Needle in and out as the Packing Nut is tightened to check packing compression. Only a slight amount of drag should be felt when sliding the needle. Excessive tightness will cause binding of the needle during Paint Gun operation.
- Remove Needle and set aside.

## NEEDLE GUIDE BODY, O-RING & SLEEVE [F], [G] & [H], (FIG 11)

- Carefully slip the Guide Body O-Ring [F] over the Needle Guide Body [G] and into the groove (AS SHOWN IN FIG 12).
- Insert the brass Needle Guide Sleeve [H] into the open end of the Needle Guide Body [G], (AS SHOWN IN FIG 12).
- Insert a long 10mm hex key (not included) into the hex of the Needle Guide Body (FIG 8), and carefully thread it into the bore until it seats (FIG 13). **NOTE:** Do Not overtighten.

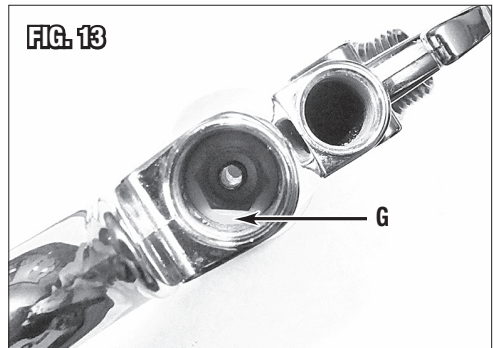
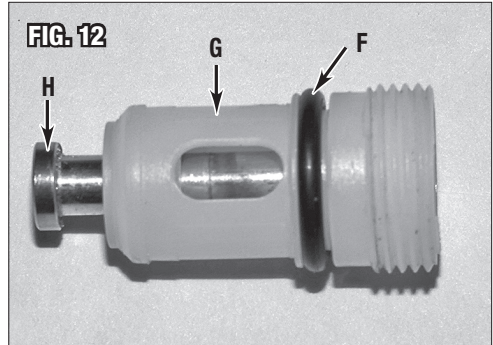
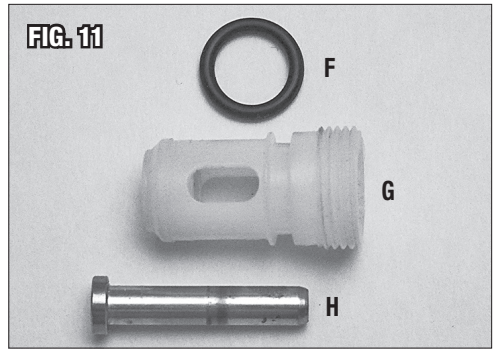

## FLUID VALVE BODY, FLUID VALVE SEAL SLEEVE & FLUID VALVE SPRING

### [C], [D] & [E]

- Place the Fluid Valve Spring [D] over the brass end of the Fluid Valve Seal Sleeve [E] and seat it onto the nylon seal (FIG 6).
- Set the opposite end of the Fluid Valve Spring [D] into the smaller open end of the Fluid Valve Body [C] (FIG 6).
- Thread the assembled Fluid Valve Body into the rear of gun body and tighten with the 17mm notch of the paint gun wrench (included with Paint Gun).

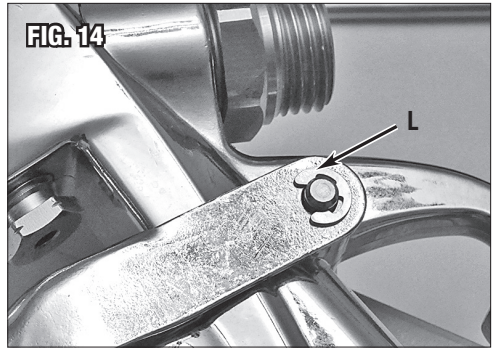

## TRIGGER/PIVOT SHAFT

- Hold the Trigger in place with the holes aligned with the hole through the gun body and insert the previously saved pivot shaft through them.
- Snap the E-Clip [L] into the shaft groove (FIG 14).

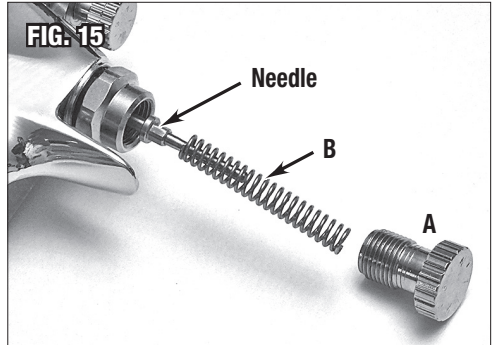

## FLUID CONTROL KNOB [A], SPRING [B] & NEEDLE

- Push Needle in into the Fluid Valve Body bore fully until it seats (FIG 15).
- Slide the Needle Tension Spring [B] over the end of the Needle (FIG 15).
- Set the Fluid Control Knob [A] over the Needle and Spring then thread it into the gun body as required.

## **FAN CONTROL VALVE ASSEMBLY [K]**

- Thread the Fan Control Valve Ass'y [K] into the upper rear of the gun body and tighten in place with the 13mm notch of the paint gun wrench (included with Paint Gun) **(FIG 10)**.

## **NOZZLE**

- Thread the Nozzle into the gun body and tighten with the 19mm notch of the paint gun wrench (included with Paint Gun).

## **AIR CAP**

- Thread Air Cap assembly onto gun body.

Your Eastwood Elite Paint Gun is now rebuilt and ready for use. Refer to the instruction manual included with the #54270 or #54271 Eastwood Elite Paint Gun Kit for set-up and adjustment procedures. If Instructions are unavailable or lost, contact Eastwood at 1-800-345-1178 or [www.eastwood.com](http://www.eastwood.com) and request Document #54278Q.

---

### **If you have any questions about the use of this product, please contact**

The Eastwood Technical Assistance Service Department: 800.343.9353 >> email: [techhelp@eastwood.com](mailto:techhelp@eastwood.com)

PDF version of this manual is available at [eastwood.com](http://eastwood.com)

The Eastwood Company 263 Shoemaker Road, Pottstown, PA 19464, USA

800.343.9353 [eastwood.com](http://eastwood.com)