



DO THE JOB RIGHT.

# 2K AERO-SPRAY CERAMIC PAINTS

PRODUCT INFORMATION SHEET Item #14145Z, 14146Z, 14147Z, 14791Z Rev. 10/13

## PRODUCT TECHNOLOGY

2K Aero-Spray™ is a high quality 2-Component ceramic-fortified urethane paint delivered by Eastwood’s unique 2-chambered aerosol. When activated the aerosol ensures the correct mix ratio to produce a super durable coating that is long lasting and beautiful. The adjustable nozzle allows you to customize the spray pattern to achieve the same results as a professional paint gun.

## Basis of Raw Material

Paint: Two-component urethane acrylic resins  
Hardener: Containing isocyanates

## VOC-Value

4.4 lbs/gal (527 g/l)

## APPLICATION

### Recommended for

Parts and auto refinishing

### Surface Preparation

Abrade surface with 320 grit prior to application. Prep surface with a wax and grease remover, such as Eastwood PRE Painting Prep. 2K Paint is compatible with most popular urethane and epoxy primers.

## ACTIVATE 2K AEROSOL

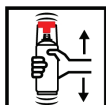

**Before activating**, shake aerosol vigorously for 2 minutes.

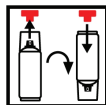

Take red button from cap. Turn aerosol 180° and attach button to pin on aerosol bottom.

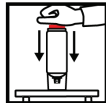

Place aerosol on firm ground – upside down. Press red button with the ball of your hand until stop is reached.



**After activating**, shake aerosol vigorously for another 2 minutes.

## Protection



Personal protection is required.  
Respiratory mask type A2/P2



Protective gloves,  
made from latex or nitrile

## APPLICATION

### Spray passes



1-2 spray passes with 50% overlap. Approx. 1.2 mil per spray pass.  
3-7 minutes flash between coats, depending on temperature.

### Drying



Full cure in 12 hours at 68°F  
35-40 minutes at 140°F (IR drying)

### Pot life

48 hours at 68°F ambient temperature. The pot life depends on the ambient temperature. Higher temperatures give a shorter pot life, lower temperatures give a longer pot life.

## CHARACTERISTICS

### Solid content

33.8% by weight relating to the diluted paint.

### Coverage

Approx. 25 - 35 sq. ft. / aerosol at a dry film thickness of 1.2mm

### Finish

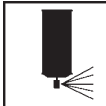

When work is finished, reverse aerosol and spray valve empty.

### Disposal

The emptied aerosols are suitable for household collection.

### Shelf life

24 months / 68°F

### Remarks

For professional use only. **Respiratory protection MUST be worn.**  
Apply in a well ventilated area away from open flame.