



DO THE JOB RIGHT.

2K AERO-SPRAY EPOXY PRIMERS

PRODUCT INFORMATION SHEET Item #14149Z, 14790Z Rev. 10/13

PRODUCT TECHNOLOGY

2K Aero-Spray™ is a high quality 2-Component epoxy primer delivered by Eastwood’s unique 2-chambered aerosol. When activated the aerosol ensures the correct mix ratio to produce a super durable coating that is long lasting and beautiful. The adjustable nozzle allows you to customize the spray pattern to achieve the same results as a professional paint gun.

Basis of Raw Material

Paint: Two-component acrylic resins
Hardener: Containing isocyanates

VOC-Value

4.7 lbs/gal (537 g/l)

APPLICATION

Recommended for

Parts and auto refinishing

Surface Preparation

Bare metal: Clean surface with Pre Painting Prep.
Painted surface: Abrade surface with 320-400 grit. Clean with PRE Painting Prep.

ACTIVATE 2K AEROSOL



Before activating, shake aerosol vigorously for 2 minutes.

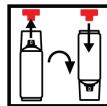

Take red button from cap. Turn aerosol 180° and attach button to pin on aerosol bottom.

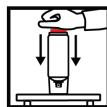

Place aerosol on firm ground – upside down. Press red button with the ball of your hand until stop is reached.

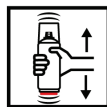

After activating, shake aerosol vigorously for another 2 minutes.

Protection



Personal protection is required.
Respiratory mask type A2/P2



Protective gloves,
made from latex or nitrile

APPLICATION

Spray passes



2 spray passes with 50% overlap. Approx. 2.8 mil per spray pass.
2-5 minutes flash between coats, depending on temperature.

Drying



Full cure in 12 hours at 68°F.
IR Drying: 35-40 minutes at 140°F
After 20-30 minutes / 68°F (20°C) recoatable wet-in-wet
If recoated after 24 hours, the 2K Epoxy Primer Filler has to be sanded first.
Wet sanding with P800, dry sanding with P400. Recoatable with any commercial 1K or 2K paint.

Pot life

48 hours at 68°F ambient temperature. The pot life depends on the ambient temperature. Higher temperatures give a shorter pot life, lower temperatures give a longer pot life.

CHARACTERISTICS

Solid content

52.5% by weight relating to the diluted paint.

Coverage

Approx. 25 - 35 sq. ft. / aerosol at a dry film thickness of 1.2mm.

Finish

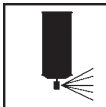

When work is finished, reverse aerosol and spray valve empty.

Disposal

The emptied aerosols are suitable for household collection.

Shelf life

24 months / 68°F

Remarks

For professional use only. **Respiratory protection MUST be worn.**
Apply in a well ventilated area away from open flame.